

EXISTING PLAN
WITH PROP STAIRS

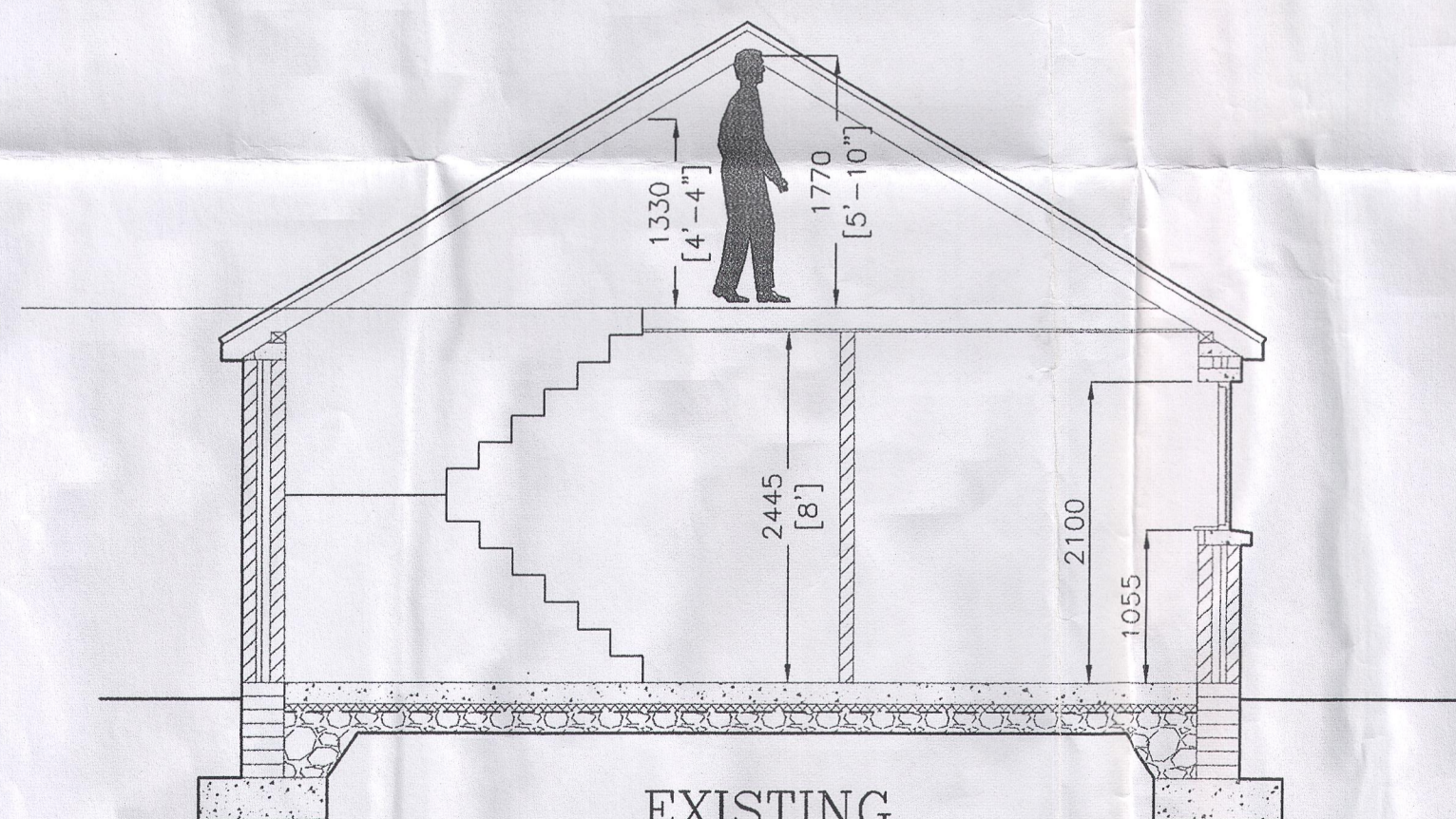

EXISTING
SECTION A-A
WITH PROP STAIRS

Community Culture & Placemaking
27 AUG 2021
RECEIVED

PLANNING PERMISSION DRAWING ONLY
ALL DRAINAGE WORKS TO BE DESIGNED AND CONSTRUCTED IN ACCORDANCE WITH THE DEPARTMENT OF THE ENVIRONMENT GUIDELINES AND REGULATIONS
ALL DIMENSIONS TO BE CHECKED ON SITE
ALL ASPECTS OF THIS DRAWING TO BE APPROVED BY THE CLIENTS ENGINEER
ALL WORKS TO BE CARRIED OUT IN ACCORDANCE WITH CURRENT BUILDING REGULATIONS

01	VM	MK	CHANGES	APR '07
Rev	Dwn	Chk	Description	Date



Drn	GO	Date	Dec 06
Chkd	GO'R	Date	Dec 06
Ref No.			

Client			
Orla Kent & Edward Shaw			
Title			
Existing Plan and Section with prop stairs at 6 Larchfield Close Commons Road, Cork			
Scale	Drawing No	Sht	Rev
1:50	06-1771		00

This document contains confidential and proprietary information of Associated CAD Solutions Ltd. and the clients thereof, and neither it nor the information contained therein shall be disclosed to others or duplicated or used by others without written consent from Associated CAD Solutions Ltd.